

CORNISH TIMES

FOUNDED 1857 (INCORPORATING LISKEARD TIMES AND GENERAL ADVERTISER)

DY MERGHER (WEDNESDAY) MYS KEVARDHU (DECEMBER) 14, 2022 9,639 £1.20

Tindle Suite, Webb's House, Liskeard PL14 6AH. Tel: 01579 342174 Fax: 01579 341851 DX No. 81651 Liskeard

BLUE SPACE
SELF STORAGE (LISKEARD)
For all your storage needs!

- Domestic & Commercial Storage
- 10-20ft Containers
- Internal Cubical Storage
- Workshop Containers
- Secure Compound
- 24/7 Access
- CCTV On Site
- Document Storage
- Boat - Caravan - Motorhome - Car Storage

www.BlueSpaceStorage.co.uk
01579 381867



**M&Co
could
close
— P3**



**Hundreds
of Santas
on bikes
— P4**



**George
and his
sleigh
— P13**

Development received 'numerous objections'

Plans for up to 70 homes rejected

By **DEBBIE PUGH-JONES**

PLANS for a residential development of up to 70 homes together with a 52-bed residential care home, a shop and a hair and beauty salon at Horizon Farm Bungalow, Bakers Hill, Tremar have again been rejected by planners who received numerous objections.

The site, on 4.7 hectares of land 700 metres south of the village, is currently occupied by large industrial scale buildings used for intensive egg production. The scheme included 18 affordable homes with a proportion of the site allocated for Extra Care Housing.

But planning officers said the proposed development was set in a location

divorced from its nearest settlements and failed to demonstrate that it would provide safe access to and from the site for all modes of transport.

It also said the proposal failed to provide financial contributions to deliver improvements to offset increased pressure on primary health care provision, the impact on the provision of public open space and on educational facilities and to mitigate against the impact of occupants on the nearby Special Area of Conservation/Special Protection Area.

They added that the applicant has not demonstrated that the additional vehicular traffic it would generate would avoid an unsafe degradation of safety levels of the road network in the parish.

• *Continued on page 3*

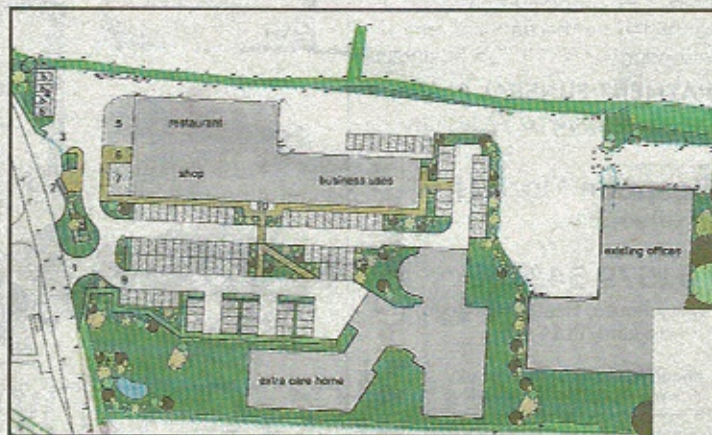

THE proposed plan included space for a residential care home, a shop and a hair and beauty salon. Picture: Cornwall Council/ Horizon Farm Ltd

Justin's
latest
column



See page 18

Lions
edge to
victory



See page 28